



TRAPO square litter bin made of wood and steel.

The KTR022.00 model has a roof, ashtray, a galvanized steel insert with a capacity of 55 liters and a system lock.

The TRAPO collection is a complete line of products distinguished by its unique appearance and ergonomics. The collection redefines the space, giving it a representative and friendly character at the same time.

Dimensions and materials available below.

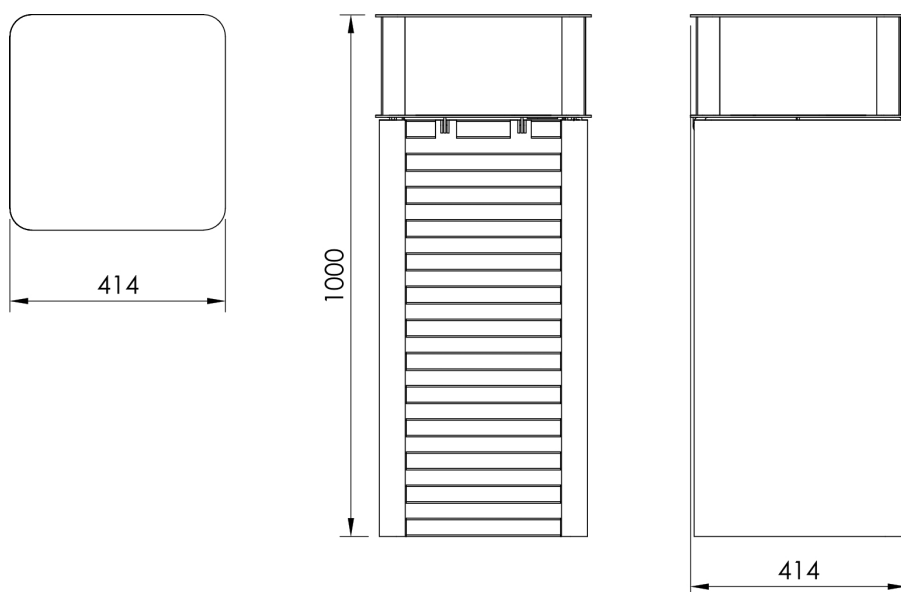

MATERIALS



SAPELI

IROKO

ASH

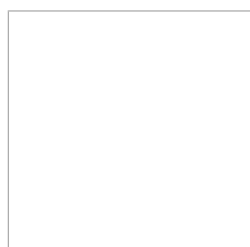



POWDER
COATED STEEL

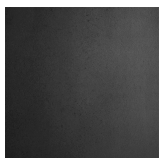

STAINLESS
STEEL

